

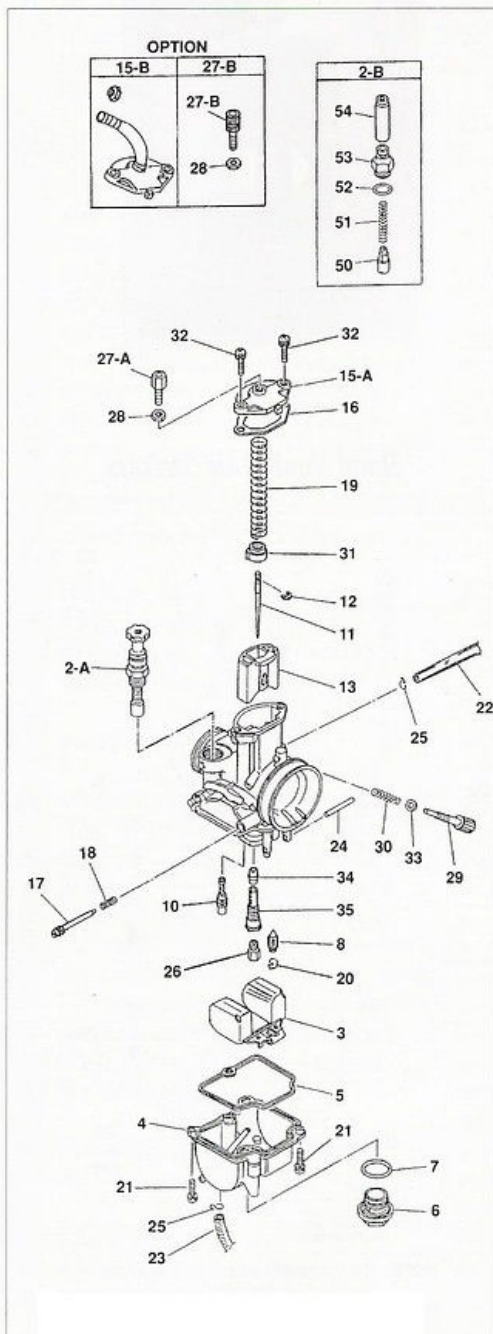

www.spracing.ch

KEIHIN PWK28



No.	DESCRIPTION	PART NO.
2A	Starter Valve Comp.	1166-818-2100
2B	Starter Valve Comp.	SEE ASTERISKED NO.
3	Float	W1310-080-9901
4	Float Bowl Comp.	N350-03A00
5	Gasket, Float Bowl	W1354-042-9900
6	Plug Screw	16162-ND4-7511-M1
7	O-Ring, Plug Screw	16173-001-0040
8	Float Valve Comp.	W1362-020-9901
10	Slow Jet	N424-21xxx
11	Jet Needle	N427-46xxx
12	Clip, Jet Needle	16115-169-0040
13	Throttle Valve	N502-52x00
15a	Top	1030-844-2000
15B	Top	1030-843-2200
16	Gasket, Top	1202-837-2000
17	Air Adjust Screw	W1446-231-9900
18	Spring, Air Adjust	W1711-416-9900
19	Spring, Throttle	1290-921-2000
20	Clip, Float Valve	0405-013-1000
21	Screw, Float Bowl	N114-0413
22	Bowl Vent Pipe	W9404-40090
23	Overflow Pipe	95003-07042-31
24	Float Pin	w9525-25250
25	Clip	W9535-35000
26	Main Jet	99101-357-xxx0
26A	Main Jet (SDGAA)	99101-393-xxx0
27A	Cable Adjuster	W9581-59250
27B	Cable Adjuster	1036-804-2000
28	Nut, Cable Adjuster	W1793-130-9900
29	Idle Adjuster	1034-831-2000
30	Spring	1290-923-2000
31	Collar, Th. Spring	1022-805-7000
32	Screw, Top	N114-04140
33	Washer	0301-078-1200
34	Needle Jet	16164-169-0040
35	Needle Jet Holder (SDGAA)	N413-11A00
35A	Needle Jet Holder	N413-12A00
*50	Starter Valve	W1275-028-9901
*51	Spring	1290-922-2000
*52	O-Ring	0901-069-6000
*53	Cable Holder	W1551-140-9900
*54	Cap	16118-166-0040